

ASSEMBLY & SET-UP

Thank You

Thank you for purchasing this product. It was carefully engineered to provide excellent performance when properly operated and maintained.

Please read this entire manual prior to operating the equipment. It instructs you how to safely and easily set up, operate and maintain your machine. Please be sure that you, and any other persons who will operate the machine, carefully follow the recommended safety practices at all times. Failure to do so could result in personal injury or property damage.

All information in this manual is relative to the most recent product information available at the time of printing. Review this manual frequently to familiarize yourself with the machine, its features and operation. Please be aware that this Operator's Manual may cover a range of product specifications for various models. Characteristics and features discussed and/or illustrated in this manual may not be applicable to all models. We reserve the right to change product specifications, designs and equipment without notice and without incurring obligation.

If you have any problems or questions concerning the machine, phone your local authorized dealer or contact us directly. We want to ensure your complete satisfaction at all times.

Throughout this manual, all references to *right* and *left* side of the machine are observed from the operating position.

Contents of Carton

- Tiller
- Handlebar Assembly
- Depth Stake Assembly
- Tine Assemblies (4)
- Wheel Assembly
- Bottle of Oil
- Operator's Manual
- Engine Operator's Manual

Assembly

References to right and left side of tiller are determined from behind the equipment in the operating position except where otherwise specified.

Recommended Tools for Assembly

- 1/2" wrench
- Clean oil funnel
- Motor oil. Refer to the Engine Operator's Manual for oil specifications and quantity required.

Tines

The tines must be installed correctly to ensure proper operation. See below for the proper tine installation:

1. The tines must be installed in the correct location and the correct order. Each tine is marked as follows:
 - A1 — Inner LH Tine
 - A2 — Outer LH Tine
 - B1 — Inner RH Tine
 - B2 — Outer RH Tine

NOTE: Images and descriptions of tine installation are referenced from the FRONT of the tiller.

2. Use two clevis pins and two cotter pins from the manual bag. From the FRONT of the tiller install the inner LH tines (A1) onto the inner left side of the shaft. Install the inner RH tines (B1) onto the inner right side of the shaft. See Figure 1.
3. Use two clevis pins and two cotter pins from the manual bag. From the FRONT of the tiller install the outer LH tines (A2) onto the outer left side of the shaft. Install the outer RH tines (B2) onto the outer right side of the shaft. See Figure 2.

NOTE: The outer tines can be placed in either of the two outside holes. The inner hole is for a 22" tilling width and the outer hole is for a 24" tilling width.

Wheel Assembly & Depth Stake Assembly

1. Remove the remaining clevis pin and cotter pin from the manual bag, install the wheel assembly into the chain case bracket as shown in Figure 3.
2. Remove the two screws from the bracket in the chain case. See Figure 4.
3. Insert the horizontal bracket into the chain case brackets and secure the depth stake assembly in place with the screws removed in Step 2. See Figure 4.

NOTE: The depth stake can be placed at various positions. For setup purposes it is suggested that the depth stake be assembled with the stake just above or level with the ground surface. See the Controls & Operation section for instructions on setting the tilling depth and adjusting the depth stake.

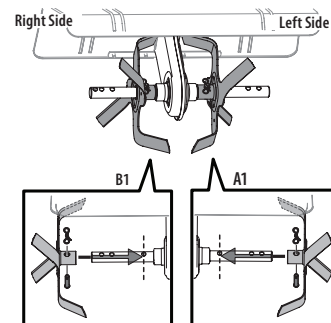

Figure 1

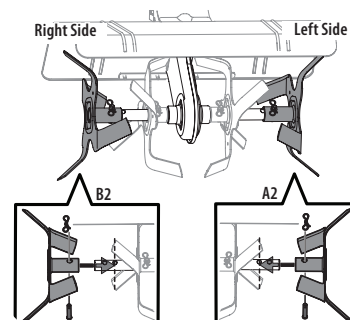

Figure 2

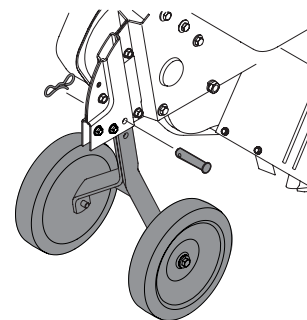

Figure 3

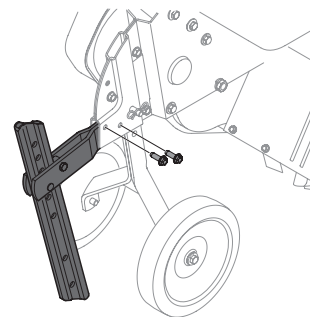

Figure 4

ASSEMBLY & SET-UP

Handle

The handle is tilted down and packaged loose for shipping purposes. To attach the handle, proceed as follows:

1. Remove the bolts, washers and nuts from the chain case bracket. See Figure 5.
2. Place the handle into position and secure with the previously removed hardware. See Figure 5.
3. Remove the handle adjustment crank from the handle. See Figure 6.
4. Rotate the handle upward and secure it in place with the handle adjustment crank. See Figure 6.
5. When the handle is in place, insert the clutch cable into the cable guide on the handle as shown in Figure 7.

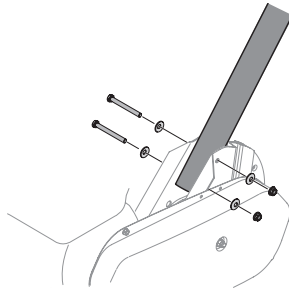

Figure 5

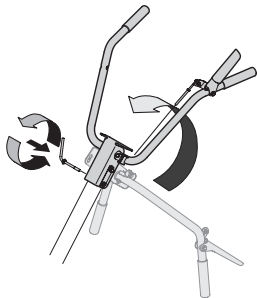

Figure 6

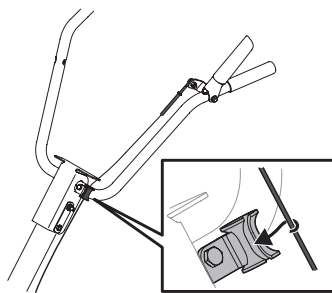

Figure 7

Adjustments



WARNING

Prior to operating your tiller, carefully read and follow all instructions below. Perform all adjustments to verify your tiller is operating safely and properly.

Wheels

The tiller is shipped with the wheels adjusted so that the machine sits level. The wheels need to be adjusted to meet your tilling needs before operation. This adjustment is made by removing the clevis pin from the wheel yoke and raising the wheels to the desired height. See Figure 8.

Depth Stake

The depth stake can also be set to adjust the tilling depth. To raise or lower the depth stake, remove the clevis pin and cotter pin, place the depth stake in the desired position and reinstall the hardware. See Figure 8.

NOTE: See the Controls & Operation section for more information.

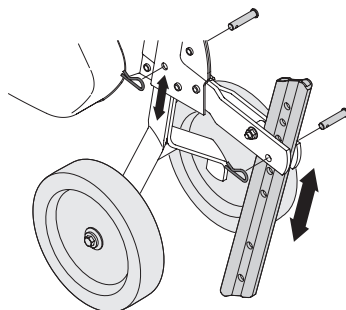

Figure 8

Clutch Cable Adjustment

Before operating the tiller, the adjustment of the forward clutch cable must be checked.

1. Disconnect and ground the spark plug wire against the engine.
2. Adjust the forward clutch cable by loosening the hex nut. See Figure 9.
3. Turn the cable collar section one or two turns to increase or decrease tension on the cable. See Figure 9.
4. Retighten the hex nut against the cable collar. See Figure 9.
5. With the forward engagement handle in the neutral (released) position, pull the starter rope several times. The tines should not turn.
6. If they turn, adjust the forward clutch cable to release tension using the previous steps in this section.
7. Check again for correct tension on the cable.
8. After tilling, if the tines stop moving, re-adjust the cable.

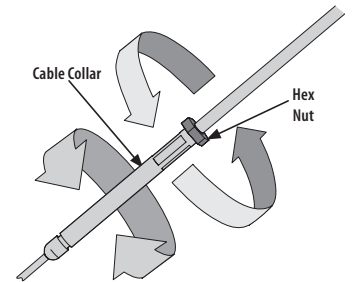

Figure 9

Set-Up

Gas & Oil Fill-Up

Service the Engine with gasoline and oil as instructed in the separate Engine Operator's Manual packed with your tiller. Read the instructions carefully.



WARNING

Use extreme care when handling gasoline. Gasoline is extremely flammable and the vapors are explosive. Never fuel the machine indoors or while the engine is hot or running.